

**FIRST RELIABLE AND
RAPID ANTIBODY BASED TEST**

Biocard COVID-19

IgM/IgG

- Qualitative detection of IgM and IgG antibodies against COVID-19 in human serum, plasma, and whole blood
- Based on Lateral flow immunochromatographic principle
- Results in less than 10 minutes
- High Sensitivity (97.4%) & Specificity (98%)

■ Ease of Use

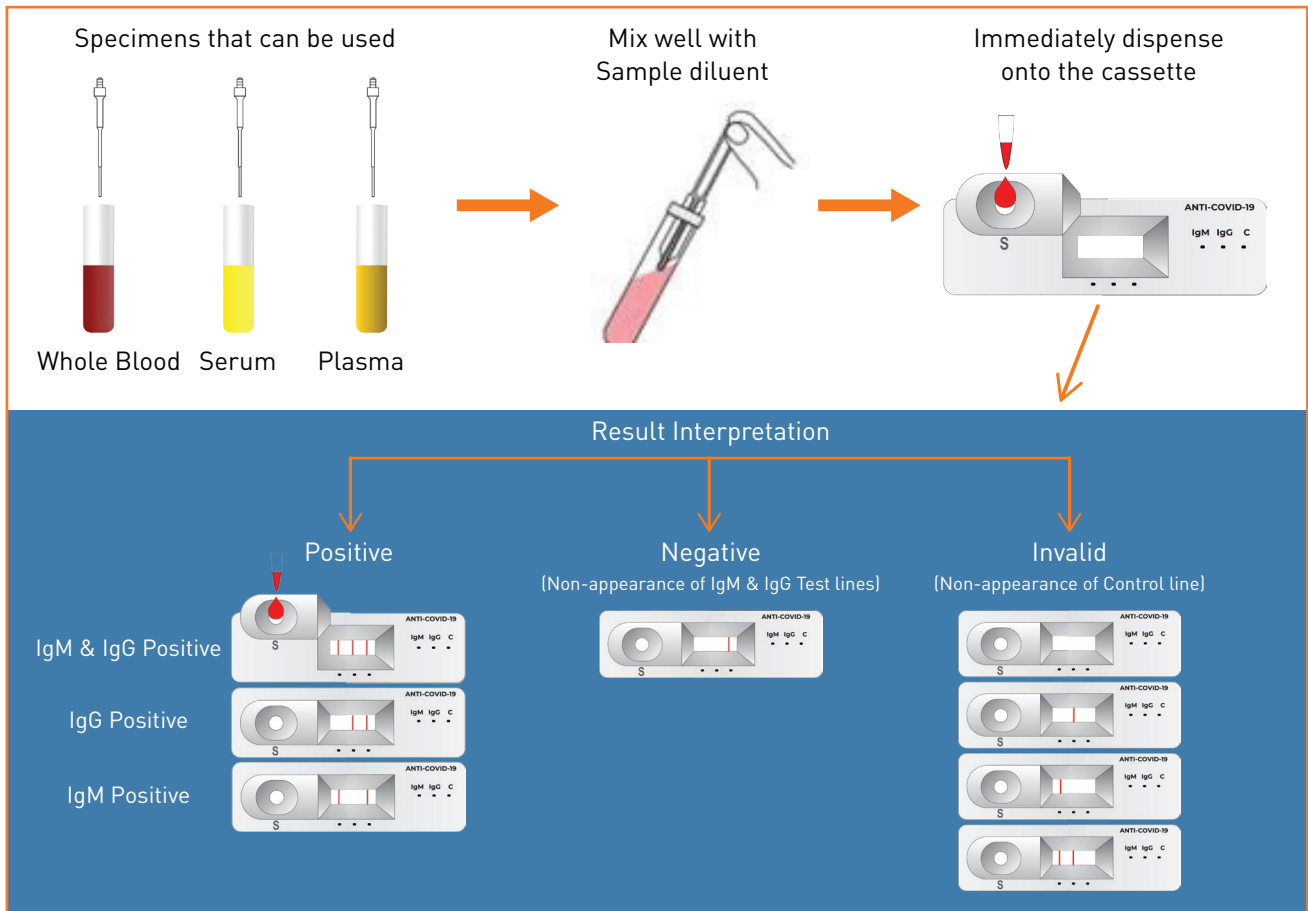

■ Superior Performance

- Simultaneous surveillance and detection of both the Covid-19 antibodies (IgM and IgG), aiding the diagnosis of present and past infection
- Highly Sensitive (97.4%) and robust test enabling the detection of infection even at low levels of antibody concentration
- Highly Specific (98%) and no cross reactivity observed with several bacterial, viral and parasitic microorganisms
- No inhibition or false positive results when tested with several potential inhibitory substances
- Straightforward result interpretation

■ Ordering Information

Product Code	Product Description	Pack Size
3-038-000	BIOCARD COVID-19 IgM/IgG	20 Tests

**For more information please order your IFU from
Labsystems Diagnostics Oy**

Tiilitie 3, FI-01720 VANTAA, Finland Tel: +358 (0) 20 155 7530
sales@labsystemsdx.com | www.labsystemsdx.com